

vtech[®]
Baby

User's Manual

Toot-Toot Animals

Safari Park



© 2014 VTech
Printed in China
91-002926-007[®]

VTech understands that a child's needs and abilities change as they grow and with that in mind we develop our toys to teach and entertain at just the right level...

vtech Baby

Toys that will stimulate their interest in different textures, sounds and colours

I am...

...responding to colours, sounds and textures

...understanding cause and effect

...learning to touch, reach, grasp, sit-up, crawl and toddle

Birth-36 months



Pre-School

Interactive toys to develop their imagination and encourage language development

I want...

...to get ready for school by starting to learn the alphabet and counting

...my learning to be as fun, easy and exciting as can be

...to show my creativity with drawing and music so my whole brain develops

3-6 years



Electronic Learning Computers

Cool, aspirational and inspiring computers for curriculum related learning

I need...

...challenging activities that can keep pace with my growing mind

...intelligent technology that adapts to my level of learning

...National Curriculum based content to support what I'm learning at school

4-10 years



To learn more about this and other VTech® products, visit www.vtechuk.com

INTRODUCTION

Thank you for purchasing the **VTech® Toot-Toot Animals Safari Park** learning toy!

Go on a trip with the **Toot-Toot Animals Safari Park** by **VTech®**. Explore and learn about animals, colours and more with the **SmartPoint™** rhino and electronic zoo. Launch the animals down the rocky path to visit the water area or the polar zone! You can also connect to other **Toot-Toot Animals** and **Toot-Toot Drivers®** play sets for even more fun! Please note SmartPoint responses may vary.

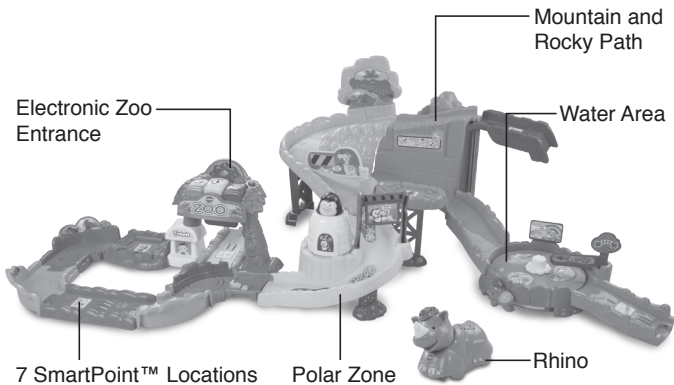

INCLUDED IN THIS PACKAGE

- One user's manual
- Two sheets of labels



- One **VTech® Toot-Toot Animals** rhino
- One electronic zoo entrance
- Two zoo entrance pillars



- One **SmartPoint™** resting area
- One **SmartPoint™** zoo entrance track
- One **SmartPoint™** polar zone ramp
- One flip-up board
- One polar zone support piece



- One penguin
- One igloo
- One **SmartPoint™** mountain
- One mountain top
- One lift insert track

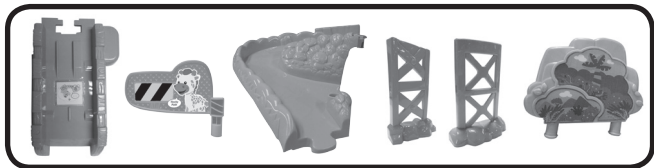

- One **SmartPoint™** lift
- One rocky path gate
- One rocky path spiral ramp
- Two mountain support pieces
- One mountain top accessory piece



- One water area
- One water area gate
- One water area ramp
- One **SmartPoint™** water area exit ramp



- Three short tracks
- Three 90 degree tracks
- One straight **SmartPoint™** track
- One cross track
- One curved piece for the cross track (changes direction)

Please stick the labels to the play set securely as indicated below:

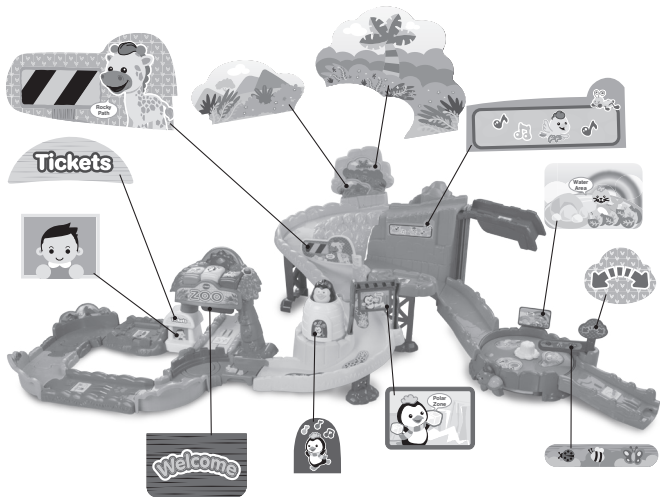

WARNING: All packing materials, such as tape, plastic sheets, packaging locks and tags are not part of this toy, and should be discarded for your child's safety.

NOTE: Please keep this instruction manual as it contains important information.

ASSEMBLY INSTRUCTIONS

With the VTech® Toot-Toot Animals Safari Park, safety comes first. To ensure your child's safety, adult assembly is required.

Electronic Zoo Entrance

1. Insert the two zoo entrance pillars into the electronic zoo entrance. You will hear a click sound to indicate the pillars are secure.
2. Attach the **SmartPoint™** zoo entrance track to the two zoo entrance pillars. You will hear a click sound to indicate the track is secure.
3. Attach the **SmartPoint™** resting area to the zoo entrance pillar with the ticket booth. You will hear a click sound to indicate the piece is secure.



Polar Zone

1. Insert the polar zone support piece into the bottom of the **SmartPoint™** polar zone ramp.
2. Insert the flip-up board into the **SmartPoint™** polar zone ramp.
3. Locate the short track piece that has a hinged slide. Insert the hinged end into the holes that are located towards the bottom of the polar zone ramp.

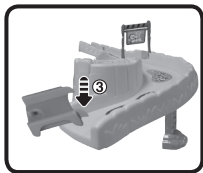

Mountain and Rocky Path

1. Attach the mountain top to the **SmartPoint™** mountain. You will hear a click sound to indicate the pieces are secure.
2. Insert the **SmartPoint™** mountain support piece into the bottom of the mountain.
3. Slide the narrow strip of the lift insert track into the slot on the side of the mountain starting at the bottom as shown in the picture.
4. Attach the **SmartPoint™** lift to the lift track.
5. Attach the rocky path spiral ramp to the mountain.
6. Insert the rocky path spiral ramp support piece into the bottom of the rocky path spiral ramp.
7. Insert the mountain top accessory piece and the rocky path gate into the rocky path spiral ramp.

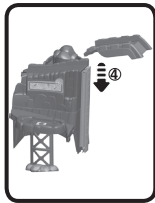
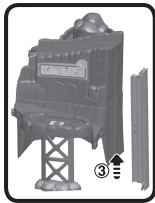
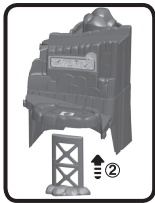
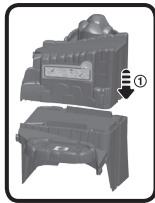

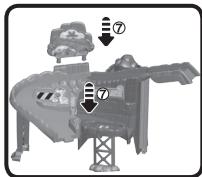
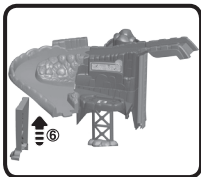
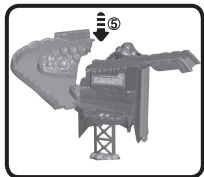

Water Area

1. Attach the **SmartPoint™** water area exit ramp and the ramp to the water area.
2. Attach the water area gate to the water area.
3. Attach the fully assembled water area to the rocky path spiral ramp as shown.

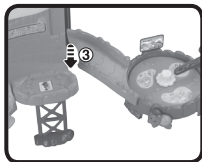
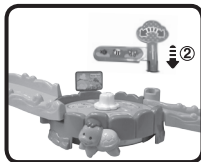
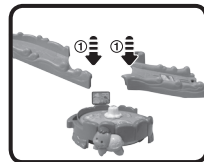

After the above steps, connect these pieces to the included track pieces. You can configure them into different arrangements.

GETTING STARTED

BATTERY INSTALLATION - Rhino

1. Make sure the unit is turned **OFF**.
2. Locate the battery cover on the bottom of the rhino. Use a coin or a screwdriver to loosen the screw.
3. Install 2 new AAA (AM-4/LR03) batteries following the diagram inside the battery box. (The use of new alkaline batteries is recommended for maximum performance.)
4. Replace the battery cover and tighten the screw to secure.

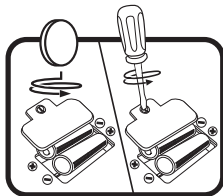

BATTERY INSTALLATION - Zoo Entrance

1. Make sure the unit is turned **OFF**.
2. Locate the battery cover on the bottom of the zoo entrance. Use a coin or a screwdriver to loosen the screw.
3. Install 2 new AAA (AM-4/LR03) batteries following the diagram inside the battery box. (The use of new alkaline batteries is recommended for maximum performance.)
4. Replace the battery cover and tighten the screw to secure.

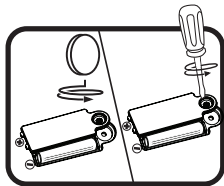

BATTERY NOTICE

- Use new alkaline batteries for maximum performance.
- Use only batteries of the same or equivalent type as recommended.
- Do not mix different types of batteries: alkaline, standard (carbon-zinc) or rechargeable (Ni-Cd, Ni-MH), or new and used batteries.
- Do not use damaged batteries.
- Insert batteries with the correct polarity.
- Do not short-circuit the battery terminals.
- Remove exhausted batteries from the toy.
- Remove batteries during long periods of non-use.
- Do not dispose of batteries in fire.
- Do not charge non-rechargeable batteries.
- Remove rechargeable batteries from the toy before charging (if removable).
- Rechargeable batteries are only to be charged under adult supervision.

DISPOSAL OF BATTERIES AND PRODUCT



The crossed-out wheellie bin symbols on products and batteries, or on their respective packaging, indicates they must not be disposed of in domestic waste as they contain substances that can be damaging to the environment and human health.



The chemical symbols Hg, Cd or Pb, where marked, indicate that the battery contains more than the specified value of mercury (Hg), cadmium (Cd) or lead (Pb) set out in Battery Directive (2006/66/EC).

The solid bar indicates that the product was placed on the market after 13th August, 2005.

Help protect the environment by disposing of your product or batteries responsibly.



For more information, please visit:

www.recycle-more.co.uk

www.recyclenow.com

PRODUCT FEATURES - Rhino

1. ON/OFF SWITCH

To turn the unit **ON**, slide the **ON/OFF SWITCH** to the **ON** () position. To turn the unit **OFF**, slide the **ON/OFF SWITCH** to the **OFF** () position.

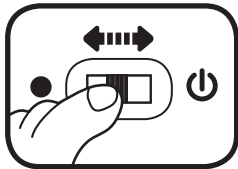

2. AUTOMATIC SHUT-OFF

To preserve battery life, the **VTech® Toot-Toot Animals** rhino will automatically power-down after approximately 60 seconds without input. The unit can only be turned on again by pressing the light-up button or pushing the rhino quickly.

ACTIVITIES - Rhino

1. Slide the **ON/OFF SWITCH** to the **ON** position to turn the unit on. You will hear a rhino sound, a song and a phrase. The light will flash with the sounds.
2. Press the **LIGHT-UP BUTTON** to hear fun sounds, sing-along songs and phrases. The light will flash with the sounds.
3. Push the rhino to hear fun sounds and melodies. While a melody is playing, push the rhino again to add in fun sounds on top of the melody. The light will flash with the sounds.
4. For added fun, the rhino interacts with **VTech® Toot-Toot Animals** play sets (each sold separately). Simply roll the rhino over one of the play set **SmartPoint™** locations to see the light flash and to hear greetings, fun sounds, short tunes and sing-along songs. You can also play with your animal on **Toot-Toot Drivers®** play sets (each sold separately). Please note SmartPoint responses may vary.

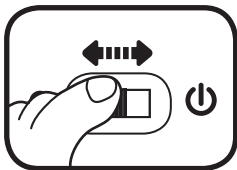

PRODUCT FEATURES – Electronic Zoo Entrance

1. OFF/EXPLORER MODE/MUSIC MODE SWITCH

To turn the unit **ON**, slide the **OFF/EXPLORER MODE/MUSIC MODE SWITCH** to the **Explorer Mode** (🔑) or the **Music Mode** (🎵) position. To turn the unit **OFF**, slide the **OFF/EXPLORER MODE/MUSIC MODE SWITCH** to the **OFF** (●) position.



2. AUTOMATIC SHUT-OFF

To preserve battery life, the **VTech® Toot-Toot Animals Safari Park** electronic zoo entrance will automatically power-down after approximately 30 seconds without input. The unit only can be turned on again by pressing any one of the three animal buttons or activating the flip-up board.

ACTIVITIES– Electronic Zoo Entrance

1. Slide the **OFF/EXPLORER MODE/MUSIC MODE SWITCH** to the **Explorer Mode** or **Music Mode** position to turn the unit **ON**. You will hear a song and a greeting phrase. The light will flash with the sounds.
2. Press the three **ANIMAL BUTTONS** to hear phrases, songs, melodies and other funny sounds. The light will flash with the sounds.



3. Push the rhino through the zoo entrance to activate the **FLIP-UP BOARD** to hear fun sounds and short tunes. The light will flash with the sounds.



4. If there is no input after approximately 8 seconds, you will hear a short tune and an invitation to play. After another 8 seconds of no input, the unit will play a short tune and then go into sleep mode. The unit can be reactivated by any input.

SING-ALONG SONGS

SING-ALONG SONG 1 LYRICS

Welcome to the zoo!

There's so much to learn and do!

SING-ALONG SONG 2 LYRICS

The zoo is fun,

Sing a song and say hello to everyone!

SING-ALONG SONG 3 LYRICS

The happy, happy penguin loves waddling,

Back and forth,

With his friends.

SING-ALONG SONG 4 LYRICS

The giraffe reaches high up in the trees,

Looking to munch on some leaves.

SING-ALONG SONG 5 LYRICS

The little, little sea turtle,

Swims happily in the sea.

Melody List

1. Polly Put the Kettle On
2. When the Saints Go Marching In
3. One Two, Buckle My Shoe
4. Muffin Man
5. Fountain in the Park
6. Can Can
7. Hickory, Dickory Dock
8. I've Been Working on the Railroad
9. Row, Row, Row Your Boat
10. Ring Around a Rosie
11. Sailing, Sailing
12. Aiken Drum

ACTIVITES – Zoo

1. Lift the rhino up to the top of the mountain using the **LIFT**.
2. Change the direction of the rocky path by moving the **GATE**.
3. Move the sliding turtle on the **WATER AREA** for the rhino to take a swim.

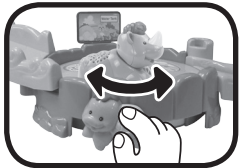

4. Move the rhino or any **SmartPoint™** animal (each sold separately) over the zoo's seven **SmartPoint™** locations to trigger fun sounds, songs, or phrases.



CARE & MAINTENANCE

1. Keep the unit clean by wiping it with a slightly damp cloth.
2. Keep the unit out of direct sunlight and away from any direct heat source.
3. Remove the batteries when the unit will not be in use for an extended period of time.
4. Do not drop the unit on hard surfaces and do not expose the unit to moisture or water.

TROUBLESHOOTING

If for some reason the program/activity stops working or malfunctions, please follow these steps:

1. Turn the unit **OFF**.
2. Interrupt the power supply by removing the batteries.
3. Let the unit stand for a few minutes, then replace the batteries.
4. Turn the unit back **ON**. The unit will now be ready to play again.
5. If the unit still does not work, replace with an entire set of new batteries.

If the problem persists, please call our Consumer Services Department on 01235 546810 (from UK) or +44 1235 546810 (outside UK) and a service representative will be happy to help you.

TECHNICAL SUPPORT

If you have a problem that cannot be solved by using this manual, we encourage you to visit us online or contact our Consumer Services Department with any problems and/or suggestions that you might have. A support representative will be happy to assist you.

Before requesting support, please be ready to provide or include the information below:

- The name of your product or model number (the model number is typically located on the back or bottom of your product).
- The actual problem you are experiencing.
- The actions you took right before the problem started.

Internet: www.vtechuk.com

Phone: 01235 546810 (from UK), or +44 1235 546810 (outside UK)

IMPORTANT NOTE:

Creating and developing **VTech®** products is accompanied by a responsibility that we take very seriously. We make every effort to ensure the accuracy of the information, which forms the value of our products. However, errors sometimes can occur. It is important for you to know that we stand behind our products and encourage you to call our Consumer Services Department on 01235 546810 (from UK), or +44 1235 546810 (outside UK), with any problems and/or suggestions that you might have. A service representative will be happy to help you.

CLASS 1
LED PRODUCT



PRODUCT WARRANTY



Thank you for choosing this quality product from VTech. We hope it will bring many hours of entertainment, imaginative play and learning.

1. The product detailed above is covered by a one year warranty from the date of purchase, against any defects in materials or workmanship.
2. The product may be returned to the place of purchase. Alternatively the product can be returned to VTech Electronics Europe plc (see address below), with proof of purchase, without proof of purchase no replacement will be provided.
3. VTech Electronics Europe plc will examine the product and if it is found to be defective due to faulty materials or workmanship, will replace the product at their discretion.
4. If the product covered by this warranty is damaged due to misuse, modification or unauthorised repair, or because of faulty batteries, battery discharge or incorrect electrical connections, then this warranty becomes void.
5. This warranty is personal to the original purchaser and is not transferable.
6. Breakages to the LCD screen are not covered by the warranty.
7. Returns to VTech Electronics Europe plc should include a cheque or postal order for £1.50 towards the cost of return postage and packaging.
8. Products returned to VTech Electronics Europe plc, should be addressed as follows and packed carefully to avoid damage in transit (Please do not include batteries or adaptor).
Please include details of the fault together with your name and address.

VTech Electronics Europe plc, c/o Tablogix Limited, 200 Milton Park, Abingdon, Oxon OX14 4TA

THIS WARRANTY IS OFFERED AS AN EXTRA BENEFIT AND DOES NOT AFFECT CONSUMERS' STATUTORY RIGHTS.

This warranty is valid for the UK and Eire only. For products purchased outside the UK and Eire, please contact your local distributor or place of purchase.

